

DELTA DA3+

DOUBLE SEAT VALVE WITH SEAT LIFTING

The DELTA DA3+ double seat valve combines all the features of a state-of-the-art hygienic mixproof valve: Water hammer safe, comprehensive cleaning mechanism including seats and shafts, minimized operation leakage, and easy service and maintenance. The DELTA DA3+ is the ultimate solution for applications requiring advanced hygienic characteristics. Like the majority of our valves, the DELTA DA3+ range, complies of course with European EHEDG guidelines.

Characteristics

The DELTA DA3+ valve is designed for hygienic applications, typically in the brewing, beverage and dairy industries as well as chemicals and pharmaceuticals.

The DELTA DA3+ valve enables comprehensive and reliable cleaning of all product-wetted parts including seat and shaft seals. The seat lifting function also ensures efficient cleaning of the leakage cavity, thus eliminating the need for spraying of the leakage cavity after upper or lower seat lifting during CIP pipeline cleaning. If required, spraying of the leakage cavity can be carried out in critical applications - either in addition to seat lifting or after closing of the valve.

Application range

The DELTA DA3+ valve is perfect for installation in any hygienic process plant where safe separation of incompatible fluids is essential. Any leakage that might occur will be safely drained off through the large leakage cavity.

Features and benefits

- Two independent seat sealing arrangements and leakage cavity with discharge to atmosphere ensure 100% safe separation of incompatible fluids.
- Minimized operating leakages. The limited residual fluid trapped between the seat ring and the valve shaft drains off to the atmosphere via the leakage cavity only when the valve closes.
- Safe against water hammer. Balanced upper and lower valve shafts maintaining the integrity of the valve even in case of a water hammer.
- Integrated seat lifting cylinder as standard. Flushing of all seat and shaft seals.
- Housing - without sump and dome. Hygienic valve design ensures perfect and fast CIP.
- No compressed air required for service.



Features and benefits continued

- No gap (crevice) between seal material and seal groove where product could get trapped. Identification numbers marked on profile seals prevent the installation of incorrect seals.
- Innovative, unique comprehensive cleaning process of all wetted surfaces including balancer, shaft seals, seat seals and leakage cavity. All product-wetted surfaces are exposed to CIP-media.
- Minimum consumption of cleaning liquids due to defined orifices optimising CIP flow during seat lift. Reduced costs for CIP-media.
- Electropolished inner surfaces Ra 0,8 µm. Shorter cleaning time.
- Low weight / compact design. For easy and efficient maintenance.
- All moving parts are contained within valve envelope during operation.

Simple maintenance

All seat seals as well as shaft seals are identical. Seal sizes are grouped over several valve sizes, for example same kit for group I (DN40, 50, 65 + 1,5", 2", 2,5", 3"), group II (DN80, 100 + 4") and group III (DN125, 150 + 5", 6"). Within each group all seals are identical.

Simple disassembly and assembly without compressed air.

The leakage cavity spray-hose does not need to be removed during maintenance.

Control units

DELTA DA3+ valves are optionally available with APV Control Unit technology for connection to the PLC system including Direct Wired, ASi-bus, Profibus or DeviceNet control alternatives.

Technical Data

SIZES	DN40 - 150 OD TUBE 1,5" - 6" IPS SH5 1,5" - 6" OTHERS ON REQUEST. MIX- MATCHED HOUSING COMBINATIONS ARE ALSO AVAILABLE
Housing types	DA31, DA32, DA33, DA34 *
Product-wetted parts	1.4404/AISI 316L. Other stainless steel parts 1.4301/AISI 304
Seal materials	EPDM/PTFE, HNBR/PTFE, FPM/PTFE and Silicon/PTFE All seals comply with the FDA requirement
Surfaces	Inside electropolished Ra 0,8µm Outside glass beaded, satin finish
Product pressure	10 bar
Max. temperature	EPDM / HNBR 135°C (short time 140°C) VMQ*/ FPM* 135°C not to be used for hot water and steam FPM 135°C not to be used for steam
Sterilization temp.	(Short - time) 150°C EPDM 140°C HNBR
Required air pressure	6 bar Valve normally closed.

*



Bodies with different angles of port orientation can be supplied

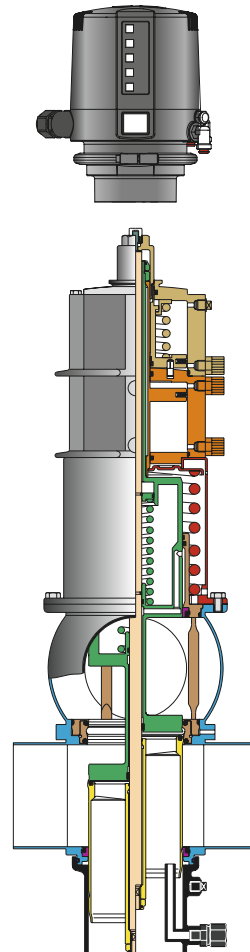

SPX®

SPX reserves the right to incorporate our latest design and material changes without notice or obligation.

Design features, materials of construction and dimensional data, as described in this bulletin, are provided for your information only and should not be relied upon unless confirmed in writing. Please contact your local sales representative for product availability in your region. For more information visit www.spx.com.

The green ">" is a trademark of SPX Corporation, Inc..

APV-8011-GB Version: 04/2014 Issued: 06/2014

SPX Flow Technology

Zeichenstrasse 49, D-59425 Unna, Germany

Phone: +49 (0) 23 03/ 108-0 Fax: +49 (0) 23 03 / 108-210

COPYRIGHT © 2009, 2012 SPX Corporation