

Valves for the Process Industry

Uniflow®



Why choosing the Uniflow® range of valves?

- Strictly compliant with legal regulations, safety and reliability.
- Full Traceability and Certification of Materials.
- NDE's carried out at casting, intermediate and final level by a combination of Independent and on site QC engineers.
- Stringent I&TP are standardized within the manufacture process
- Wide range of available materials include cast and alloy steel, stainless steel, forged and exotic.
- First line after market response
- Versatility with valve styles, actuation and valve modification.



Product Type	Material	Class, nominal pressure and size	Temperature range
Ball valves	WIPACON A, PL	CLASS 1500, 2000 & 3000 CLASS 1500, 2000 & 3000 CLASS 1500, 2000 & 3000 CLASS 1500, 2000 & 3000	CLASS 1500: 0°C to 150°C CLASS 2000: 0°C to 150°C CLASS 3000: 0°C to 150°C
Globe valves	WIPACON A, PL	CLASS 1500, 2000 & 3000 CLASS 1500, 2000 & 3000 CLASS 1500, 2000 & 3000	CLASS 1500: 0°C to 150°C CLASS 2000: 0°C to 150°C CLASS 3000: 0°C to 150°C
Check valves	WIPACON A, PL	CLASS 1500, 2000 & 3000 CLASS 1500, 2000 & 3000 CLASS 1500, 2000 & 3000	CLASS 1500: 0°C to 150°C CLASS 2000: 0°C to 150°C CLASS 3000: 0°C to 150°C
Ball valves	WIPACON A, PL	CLASS 1500, 2000 & 3000 CLASS 1500, 2000 & 3000 CLASS 1500, 2000 & 3000	CLASS 1500: 0°C to 150°C CLASS 2000: 0°C to 150°C CLASS 3000: 0°C to 150°C
Strainers	WIPACON A, PL	CLASS 1500, 2000 & 3000 CLASS 1500, 2000 & 3000 CLASS 1500, 2000 & 3000	CLASS 1500: 0°C to 150°C CLASS 2000: 0°C to 150°C CLASS 3000: 0°C to 150°C

Quality valves designed and certified in compliance with PED 2014/68/EU

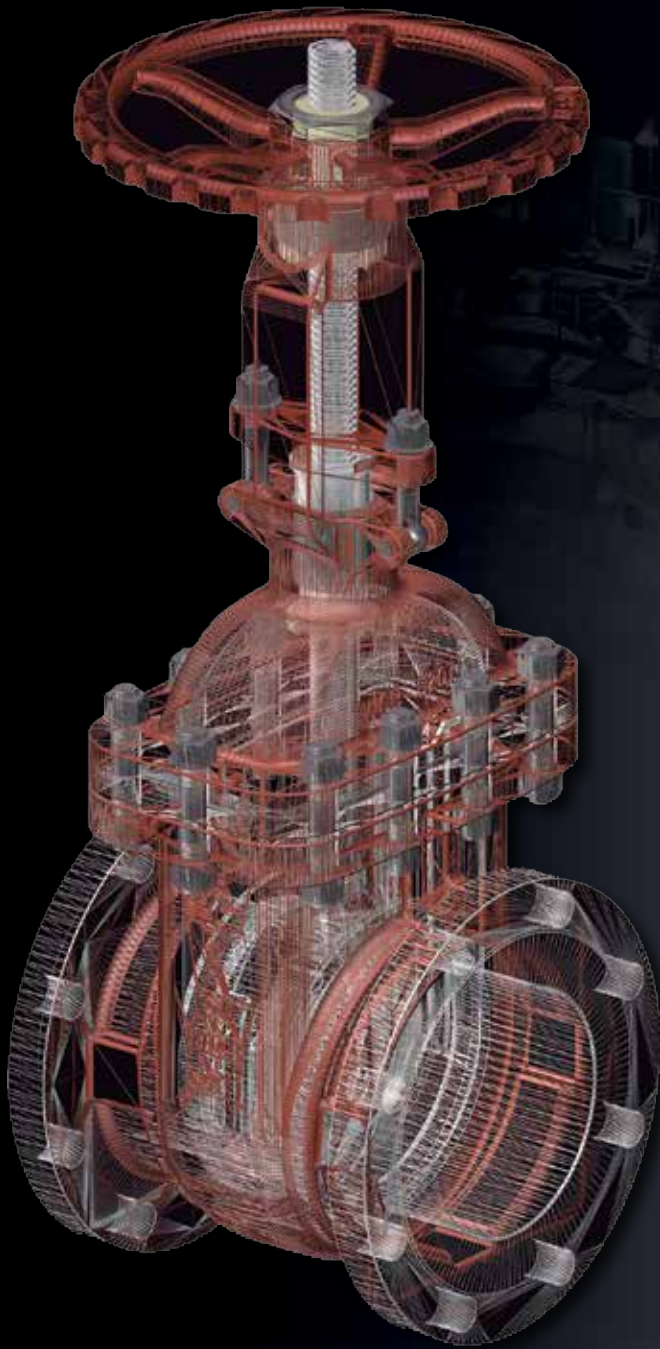

Rugged Valves, built to last – a vast portfolio designed in conformity with EN and ASME / API standards.

Valves for General Industry and Power



Ensure your traceability!

Uniflow[®]



CAST API / EN Industrial Valves

Gate Valves Series 90, 91, 92, 94

2" - 48" / DN50 - DN1200 / Class 150-2500 / PN16-420 / Connections RF, RTJ, BW / Standard Design: API 600 / API 6D / ASME B16.34 /

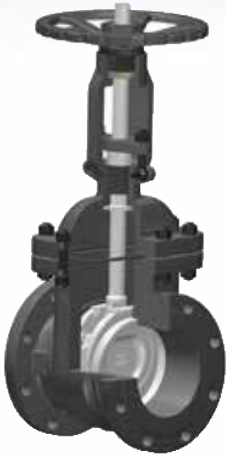

Standard Features:

- Metal seated, bidirectional
- OS&Y, pressure seal design for high ratings
- Rising stem
- Back seating design
- Flexible wedge
- Threaded, welded or integral seat

Options:

- Non-rising stem
- Solid wedge
- Bellows seal (Fig. 94)
- Top arrangement for actuator assembly
- Pneumatic, electric or hydraulic actuation
- Lock device, chainwheel
- Position indicator, limit switches
- Packing with lantern ring
- Live load packing
- Bypass line, drain device available
- Extended bonnet and stem for cryogenic application
- Jacketed body
- Vacuum service design
- Manufacturing to NACE MR0175
- Special execution for outdoors/corrosive atmosphere, high temperature service, etc.

Globe Valves Series 80, 81, 82, 83, 84, 85, 86

2" - 24" / DN50 - DN600 / Class 150-2500 / PN16-420 / Connections RF, RTJ, BW / Standard Design: BS 1873 / ASME B16.34 /



Standard Features:

- Metal seated, unidirectional
- OS&Y, pressure seal design for high ratings
- Non-rising stem and handwheel
- Back seating design
- Threaded, welded or integral seat

Options:

- Rising stem and handwheel
- Parabolic plug for throttling/regulating function
- Top arrangement for actuator assembly
- Pneumatic, electric or hydraulic actuation
- Lock device, chainwheel
- Position indicator, limit switches
- Packing with lantern ring
- Live load packing
- Bypass line, drain device available
- Jacketed body
- Extended bonnet and stem for cryogenic application
- Vacuum service design
- Manufacturing to NACE MR0175
- Special execution for outdoors/corrosive atmosphere, high temperature service, etc.

Ball Valves Series BV BF

3/8" - 10" / DN10 - DN250 / Class 150-600 / PN16-100 / Connections RF, RTJ, BW / Standard Design: API6D / ASME B16.34 /



Standard Features:

- Metal or soft seated, bidirectional
- 2 pieces or 3 pieces body
- Full bore or reduced bore
- Solid or light ball
- Blow-out proof stem
- Body cavity pressure relief

Options:

- Anti-static design
- Drain and vent connections
- Injection sealing
- Top arrangement to ISO 5211 for actuator assembly
- Lock device, chainwheel
- Position indicator, limit switches
- Live load packing
- Fully welded construction
- Bypass line
- Jacketed body
- Underground application structure available
- Cryogenic design, vacuum service design
- NACE MR0175 design
- Fire safe design to API 6FA
- Special execution for outdoors/corrosive atmosphere, high temperature service, etc.

Check Valves Series 3S, 31

2" - 36" / DN50 - DN900 / Class 150-2500 / PN16-420 / Connections RF, RTJ, BW / Standard Design: API 6D / ASME B16.34 /



Standard Features:

- Metal seated
- Pressure seal design for high ratings
- Full bore design

Options:

- Counterweight and hydraulic
- Tilting design
- Jacketed body
- Special execution for outdoors/corrosive atmosphere, high temperature service, etc.



* Other complementary UNIFLOW products on demand:
Plug Valves



FORGED API Industrial Valves

Forged Gate Valves Series 99

3/8" - 2" / DN10 - DN50 / Class 800-2500 / Connections RF, BW, SW, BSPP, BSPT, NPT / Standard Design: API 602 / ASME N16.34

Features/Options:

- Metal seated, bidirectional
- OS&Y, pressure seal design for high ratings
- Rising stem
- Back seating design
- Flexible or solid wedge
- Threaded, welded or integral seat
- Operation by Handwheel or Gear

Options:

- Flexible wedge
- Top arrangement for actuator assembly
- Pneumatic, electric or hydraulic actuation
- Lock device, chainwheel
- Position indicator, limit switches
- Packing with lantern ring
- Live load packing
- Bypass line, drain device available
- Extended bonnet and stem for cryogenic application
- Vacuum service design
- Manufacturing to NACE MR0175
- Special execution for outdoors/corrosive atmosphere, high temperature service, etc.



Forged Globe Valves Series 89

3/8" - 2" / DN10 - DN50 / Class 800-2500 / Connections RF, BW, SW, BSPP, BSPT, NPT / Standard Design: API 602 / ASME N16.34

Features/Options:

- Metal seated, unidirectional
- OS&Y, pressure seal design for high ratings
- Rising stem and handwheel
- Back seating design
- Parabolic plug for throttling/regulating function
- Threaded, welded or integral seat
- Operation by Handwheel or Gear

Options:

- Top arrangement for actuator assembly
- Pneumatic, electric or hydraulic actuation
- Lock device, chainwheel
- Position indicator, limit switches
- Packing with lantern ring
- Live load packing
- Bypass line, drain device available
- Extended bonnet and stem for cryogenic application
- Vacuum service design
- Manufacturing to NACE MR0175
- Special execution for outdoors/corrosive atmosphere, high temperature service, etc.



Forged Check Valves Series 39 / 35

3/8" - 2" / DN10 - DN50 / Class 800-2500 / Connections RF, BW, SW, BSPP, BSPT, NPT / Standard Design: API 602 / ASME N16.34

Features/Options:

- Metal seated
- Pressure seal design for high ratings
- Regular port design
- Piston or swing check design

Options:

- Special execution for outdoors/corrosive atmosphere, high temperature service, etc.



Forged Y-Strainers Series F9

3/8" - 2" / DN10 - DN50 / Class 800-2500 / Connections RF, BW, SW, BSPP, BSPT, NPT / Standard Design: BS 5352 / ASME B16.34

Features/Options:

- Replaceable screen
- Screen made of wire mesh or perforated basket, with full range of available commercial widths/perforations
- Bolted cover or pressure seal cover for high sizes/ratings

Options:

- Special execution for outdoors/corrosive atmosphere, high temperature service, etc.



* Other complementary UNIFLOW products on demand:
Plug Valves



API / EN Industrial Valves

Y-Strainers Series F0

2" - 24" / DN50 - DN600 / Class 150-600 / PN16-100 / Connections RF, RTJ, BW / Standard Design: API 6D / ASME B16.34 /



Features/Options:

- Replaceable screen
- Screen made of wire mesh or perforated basket, with full range of available commercial widths/perforations
- Bolted cover or pressure seal cover for high sizes/ratings

Options:

- Special execution for outdoors/corrosive atmosphere, high temperature service, etc.

Dual Plate Check Valves Series DP

2" - 24" / DN50 - DN600 / Class 150-2500 7 PN16-420 / Connections RF, RTJ, BW / Standard Design: BS 1873 / ASME B16.34 /



Standard Features:

- Retainless design
- Metal seated

Options:

- Special execution for outdoors and corrosive atmosphere, high temperature service, etc

Forged Ball Valves Series BV B8

3/8" - 2" / DN10 - DN50 / Class 800-2500 / Connections RF, BW, SW, BSPP, BSPT, NPT / Standard Design: API 6D / ASME N16.34

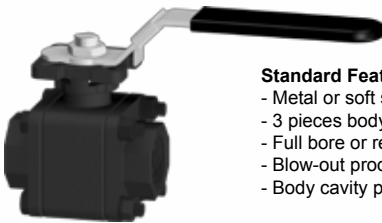

Standard Features:

- Metal or soft seated, bidirectional
- 3 pieces body
- Full bore or reduced bore
- Blow-out proof stem
- Body cavity pressure relief

Options:

- Anti-static design
- Drain connection
- Top arrangement to ISO 5211 for actuator assembly
- Lock device, chainwheel
- Position indicator, limit switches
- Fully welded construction
- Cryogenic design, vacuum service design
- NACE MR0175 design
- Fire safe design to API 6FA
- Special execution for outdoors/corrosive atmosphere, high temperature service, etc.

Trunnion Ball Valves Series BV BT

2" - 36" / DN50 - DN900 / Class 150-2500 / PN16-420 / Connections RF, RTJ, BW / Standard Design: API6D / ASME B16.34 /



Standard Features:

- Metal or soft seated, bidirectional
- 2 pieces or 3 pieces body
- Full bore or reduced bore
- Solid or light ball
- Blow-out proof stem
- Body cavity pressure relief
- Cast or forged material

Options:

- Anti-static design
- Top or side entry
- Double block and bleed feature (DBB)
- Double piston effect function (DPE)
- Drain and vent connections
- Injection sealing
- Top arrangement to ISO 5211 for actuator assembly
- Lifting lugs and supporting feet
- Lock device, chainwheel
- Position indicator, limit switches
- Live load packing
- Fully welded construction
- Bypass line
- Jacketed body
- Undergorund application structure available
- Cryogenic design, vacuum service design
- NACE MR0175 design
- Fire safe design to API 6FA
- Special execution for outdoors/corrosive atmosphere, high temperature service, etc.

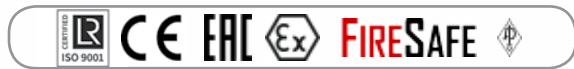

* Other complementary UNIFLOW products on demand:
Plug Valves



Stem Bellow sealing, free of maintenance and emissions. Environmental friendly. (Globe and Gate Valves)



Complete range of automation capabilities, all actuator brands available.



Optional with bare stem, for your personal actuator selection and installation.



Throttling Plug for modulating service, linear and equal percentage characteristics. (Globe Valves)

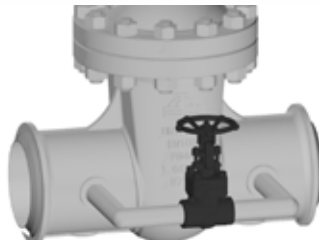

Optional by pass to optimize system and/or valve performance.

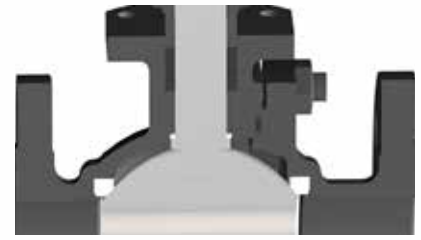

Fire Safe Design to API 6FA (Ball Valves)



Backseat bushing which isolates the packing from flow exposure at valve open. (Globe and Gate valves)

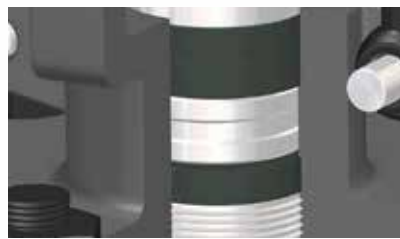

The use of lantern rings greatly increases the life of packing. This is an optional feature in most of the range.



Double block and bleed and emergency sealant system. (Trunnion Mounted Ball Valves)



Automation and design enhancements:

Actuation Packages:

- Electric actuators of the most reliable international manufacturers are assembled and adjusted prior to delivery.
- Pneumatic actuators –linear or quarter turn fitted to each valve style and thrust or torque.
- Control accessories: limit switches with / without junction box arrangement, positioners, solenoids, compression fittings...
- Locking devices, interlocking and hoods.

Engineering Specifications:

- All Painting and coating systems available .
- NDE's – RX, LPT, MPI.

Valve Modification:

- Extended spindles for underground duties.
- External bypass.
- Flange finish/welded ends to schedule.
- Special bolting material.

On site and Off site after market service



Uniflow® Valves; Quality Approval as defined by PED 2014/68/EU – Annex III Module H.

